



LAYCOCK SYSTEMS, INC.

1601 North 43rd Street, Tampa, FL 33605

Ph: 813-248-3555 / Fax: 813-242-0514

Email: sales@laycocksystems.com / Web: www.laycocksystems.com

INSTRUCTIONS FOR THE INSULATION FORMER

CROWN MODEL 2301 and 2301M

WARNING: EXCESSIVE CREASING ROLLER PRESSURE WILL DAMAGE POLYURETHANE ROLLER. DO NOT OPERATE WITHOUT INSULATION PAPER IN ROLLERS OR DAMAGE TO THE POLYURETHANE ROLLER WILL RESULT.

Operation:

To Adjust for width of trough:

In setting up for operation, the first adjustment is for desired width of trough. Loosen Allen head setscrews in both creasing rollers and slide on shaft to desired width using graduations on top of scale.

To Adjust Guide Brackets:

To adjust the guide brackets for width of insulation strips, loosen the wing nuts and slide brackets to desired width, using graduations on bottom of scale, then finger tighten wing nuts.

To Adjust for Various Thicknesses of Insulation:

Two thumb screws located at either end of the roller guide supporting shaft, raise or lower this shaft for various thicknesses of insulation. For thicker insulation, these should be turned farther down to provide more pressure between creasing rollers and polyurethane roller. Creasing rollers should always run across the grain of the insulation.

For Model 2301 M. Press the foot switch to activate the motor that operates the Insulation Former. Insulation is guided by two (2) brackets and fed between the creasing rollers and a polyurethane roller for forming.

For Model 2301. Fasten the Insulation Former to the top of bench with wood screws or bolts.

NOTE: Allen Head Wrench for making all adjustments is conveniently located on left side of unit.

Lubrication:

An occasional drop of oil on either end of the creasing roller shaft and polyurethane roller shaft provides for easier operation and longer life.

STORAGE

When not in use, cover unit within a plastic bag.

WARRANTY

Crown's Motor Repair Equipment is warranted to the original owner against defects in materials and workmanship for ninety (90) days from date of purchase. Any part found to be defective (except by overloading, misuse, neglect, fire, accident, tampering with by unauthorized serviceman, or other cause beyond the manufacturer's control), will be replaced or repaired free of charge.

SPECIFICATIONS FOR INSULATION FORMER**Construction:**

Iron base & Aluminum hand wheel.

Steel creasing rollers and guides.

Insulation Capacity:

8" maximum width, unlimited length. 6" maximum troughs.

Features:

Easy-to-read scale for fast setups. Adjustable tension for creasing rollers.

Operation:

Insulation is guided by two (2) brackets and fed between the creasing rollers and a polyurethane roller for forming.

Polyurethane roller prevents the creasing rollers from cutting the insulation.

Spare Parts: To be recommended upon request.

Enclosures:

Operating Instructions and equipment repair/replacement parts list.

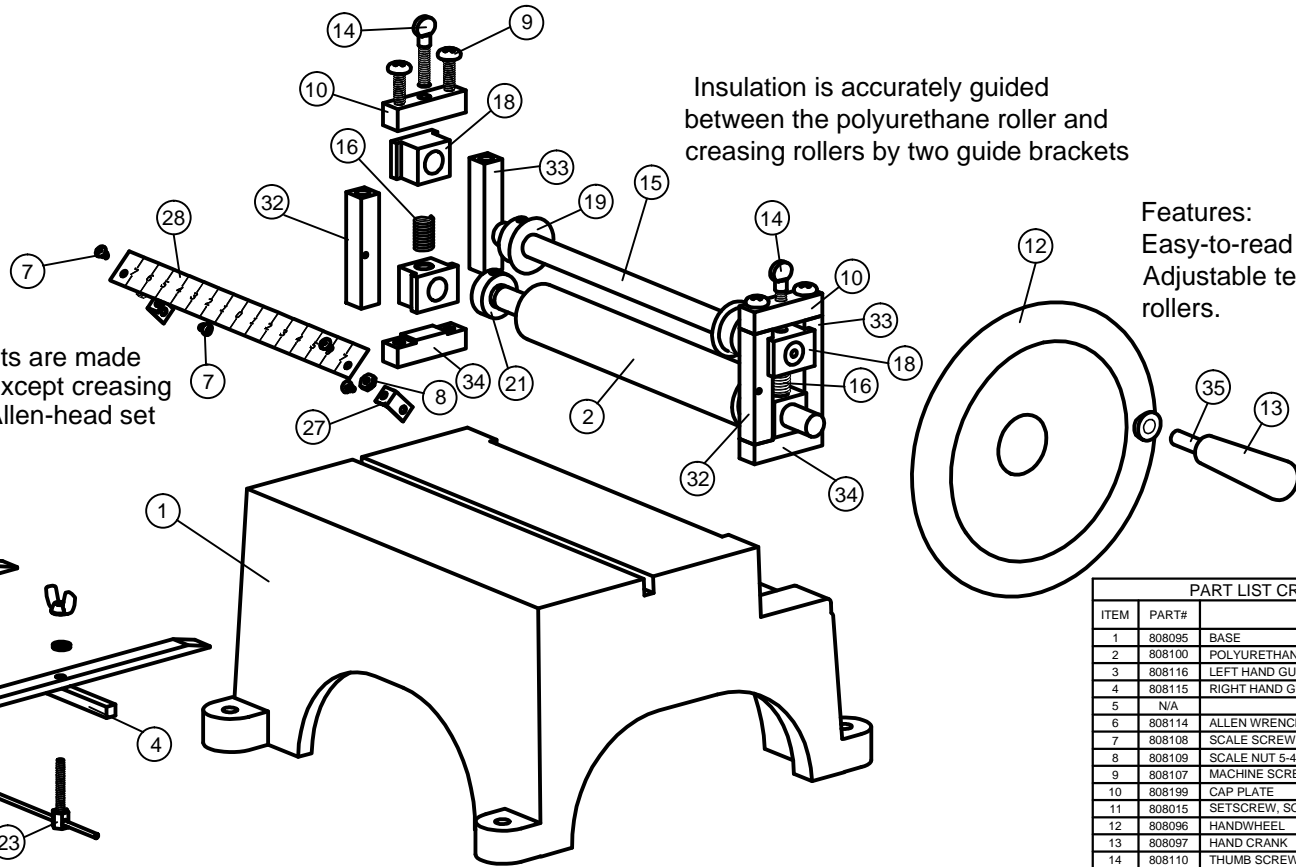
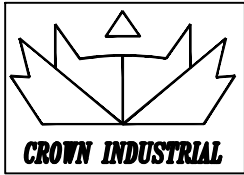

Insulation is accurately guided between the polyurethane roller and creasing rollers by two guide brackets

Features:
Easy-to-read scale for fast setups.
Adjustable tension for creasing rollers.

All set-up adjustments are made with thumbscrews, except creasing rollers, which have Allen-head set screws.

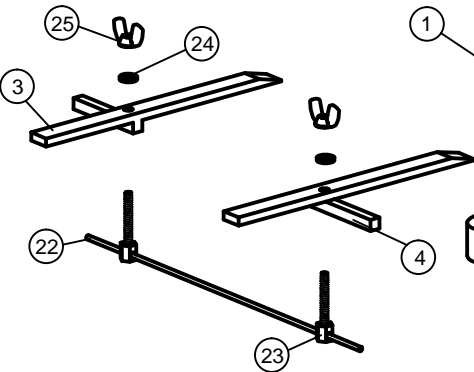

This insulation former will form slot insulation quickly and neatly, plain or cuffed, up to 8" wide with any length. It insures uniform slot liners; speeding winding and preventing burnout's due to improperly fitting or torn slot lining.

**PART LIST
CROWN MODEL 2301**

Operation:
Insulation is guided by two (2) brackets and fed between the creasing rollers and a polyurethane roller for forming. Polyurethane roller prevents the creasing rollers from cutting the insulation.

PART LIST CROWN MODEL 2301			
ITEM	PART#	DESCRIPTION	QUANTITY
1	808095	BASE	1
2	808100	POLYURETHANE ROLLER	1
3	808116	LEFT HAND GUIDE BRACKET	1
4	808115	RIGHT HAND GUIDE BRACKET	1
5	N/A		
6	808114	ALLEN WRENCH	1
7	808108	SCALE SCREW, 5-40X3/16"	4
8	808109	SCALE NUT 5-40	2
9	808107	MACHINE SCREW, 1/4-27X3/4"	4
10	808199	CAP PLATE	2
11	808015	SETSCREW, SOCKET HEAD 1/4-20X1/4"	3
12	808096	HANDWHEEL	1
13	808097	HAND CRANK	1
14	808110	THUMB SCREW	2
15	808101	SHAFT, CREASING ROLLER	1
16	808103	COMPRESSION SPRING	2
17	808037	SETSCREW, SKT.HD, 10-24X3/16"	2
18	808099	BEARING BLOCK (B.B)	4
19	808117	CREASING ROLLER	2
20	808120	BRASS PLUG	2
21	808118	COLLAR SPACER, ROLLER	2
22	808111	STEEL ROD	1
23	808113	ROD SCREW, SQ HD SPECIAL	2
24	808122	GUIDE WASHER, 1/4X5/8X1/16"	2
25	808112	WING NUT 10-24	2
26	N/A		
27	808121	SCALE CLIP	2
28	808102	SCALE	1
29	N/A		
30	808207	SCREW, BASE PLATE TO PILLAR, 1/4-28X5/8"	4
31	808105	SCREW, SOCKET HEAD, 1/4-20X5/8"	2
32	808200	FRONT PILLAR, (B.B. HOLDER)	2
33	808201	REAR PILLAR, (B.B. HOLDER)	2
34	808202	BASEPLATE, (B.B. HOLDER)	2
35	808400	STUD 5/16-18X2"	1
36	808025	HEX NUT 5/16-18	1

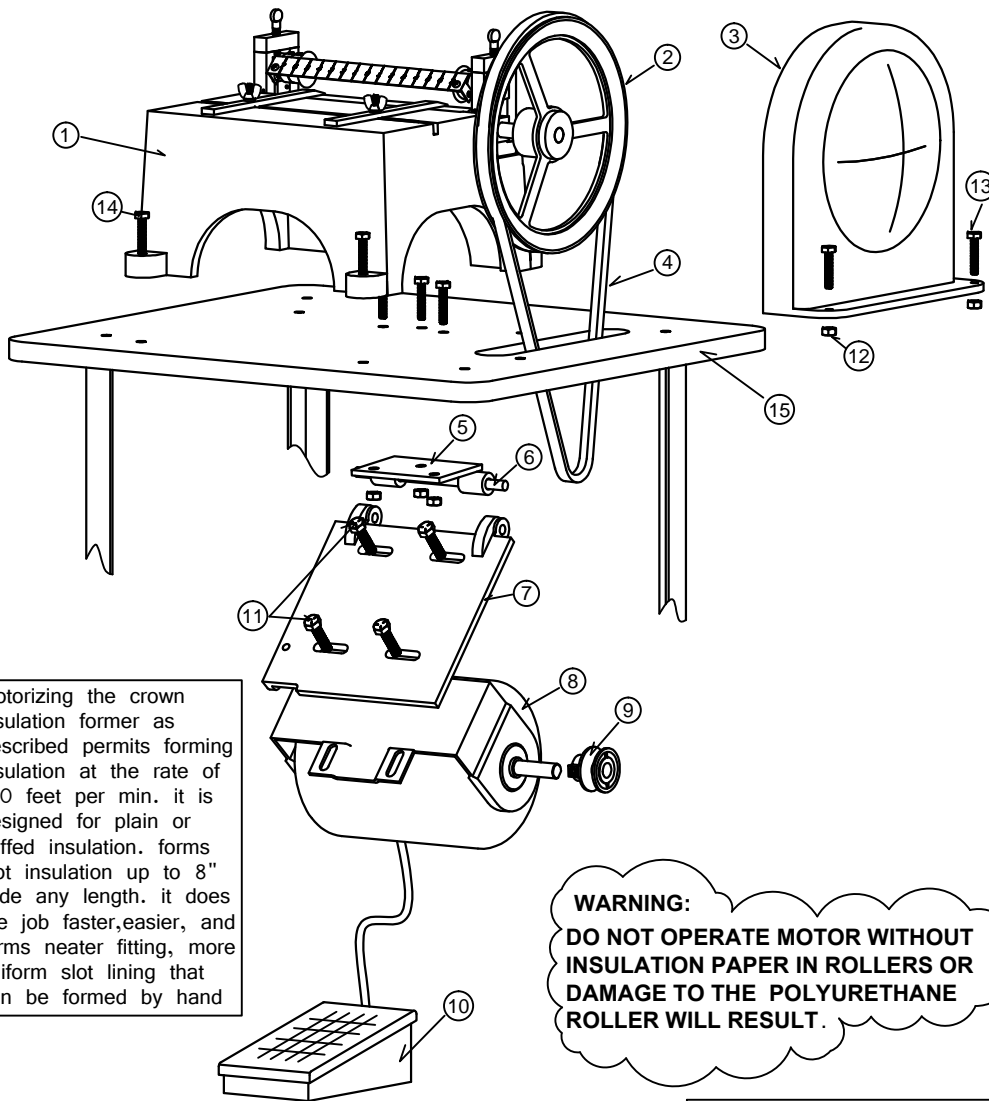

Motorizing the crown insulation former as described permits forming insulation at the rate of 100 feet per min. it is designed for plain or cuffed insulation. forms slot insulation up to 8" wide any length. it does the job faster,easier, and forms neater fitting, more uniform slot lining that can be formed by hand

WARNING:
DO NOT OPERATE MOTOR WITHOUT INSULATION PAPER IN ROLLERS OR DAMAGE TO THE POLYURETHANE ROLLER WILL RESULT .

PART LIST CROWN MODEL 2301 M

ITEM	PART#	DESCRIPTION	QTY
1	C2301	INSULATION FORMER	1
2	C804001	DRIVEN SHEAVE,8"DIA	1
3	C808069	COVER	1
4	C804002	"A"SECTIONSTD"V"BELT	1
5	C804003	HINGE	1
6	C807015	PIN Ø3/8 "	1
7	C807007	MOTOR BASE	1
8	C804004	MOTOR 115 VOLT	1
9	C804005	DRIVING SHEAVE,1.5" DIA	1
10	C804006	POWER FOOT SWITCH	1
11	N/A	5/16-18 HEX HEAD SCREWS	4
12	N/A	1/4-20 HEX NUTS	9
13	N/A	1/4-20x2" HEAD SCREWS	4
14	N/A	1/4-20x1.25" HEAD SCREWS	5
15	C804007	HEAVY DUTY WORKSTATION	1
N/A	N/A	5/16-18 HEX NUTS	4

Operation:

Press the foot switch to activate the motor that operates the Insulation Former. Insulation is guided by two (2) brackets and fed between the creasing rollers and a polyurethane roller for forming.
All set-up adjustments are made same as 2301

MOTORIZED CROWN INSULATION FORMER #2301M

